

3 MOUNT ADHESIVE FEET

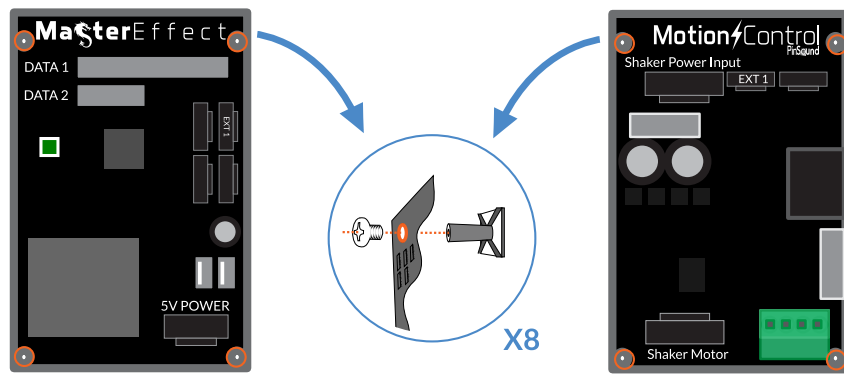

4 STICK THE BOARDS & CONNECT

- ✓ Connect EXT1 from Master Effect to Motion Control
- ✓ Connect J101 splitter to "Shaker Power Input" (Motion Control)
- ✓ Connect "Shaker Motor" wire and lay it down to the cabinet
- ✓ Connect J118 splitter to "5V DC POWER / P1" (Master Effect)
- ✓ Connect the ribbon extender from DMD board to Master Effect

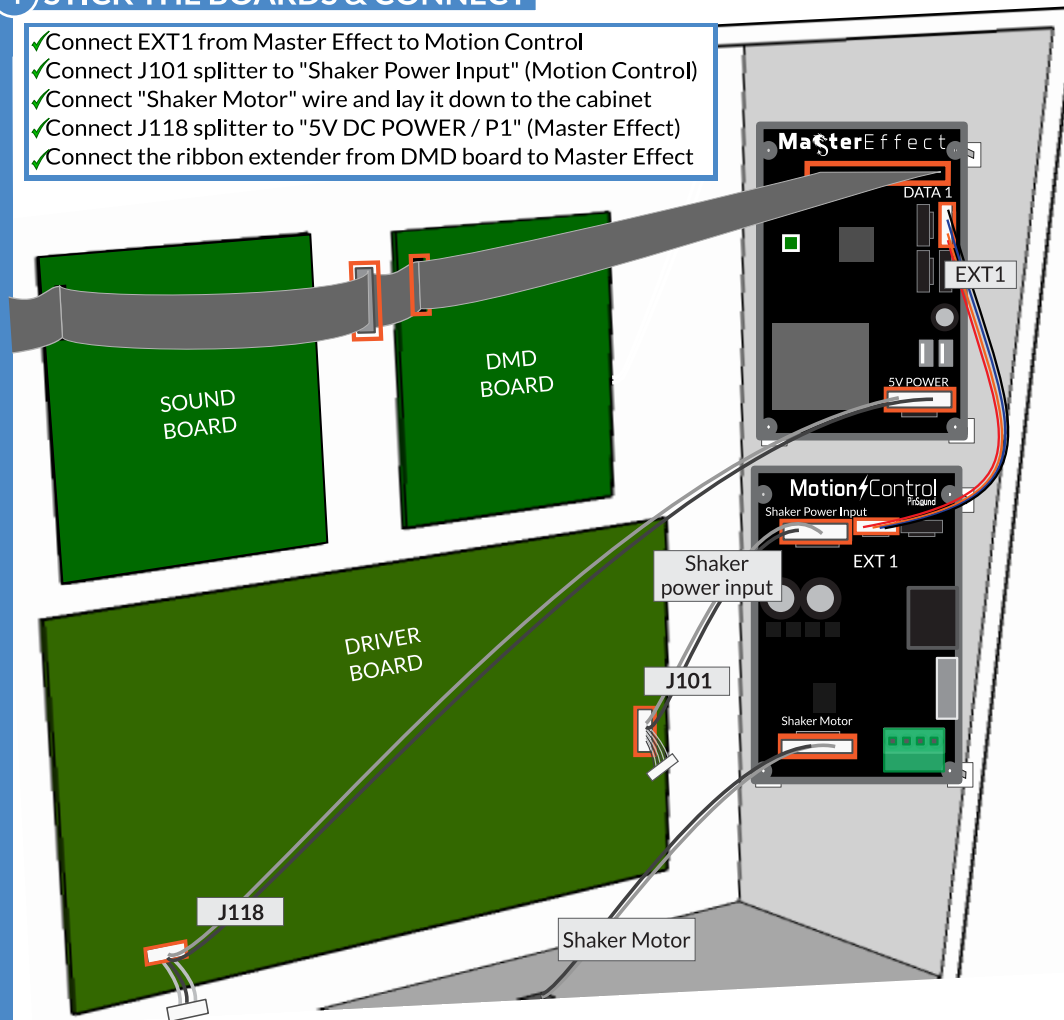

5 PREPARE THE DRILL AND THE TEMPLATE

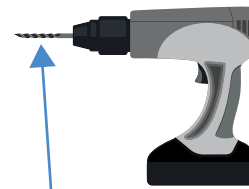

7/32" (5.5mm) drill bit

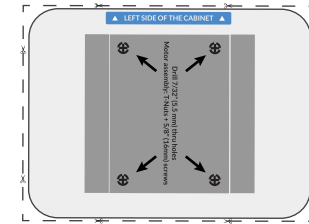

Cut off the WPC drill template

6 PREPARE THE SHAKER FITTING

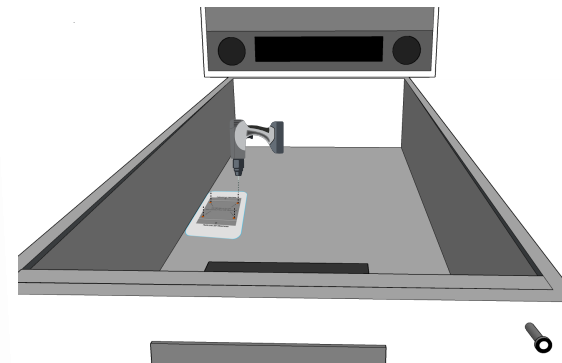

Place the template as indicated* and drill the 4 holes

(* you may have to choose another position to fit in your cabinet)

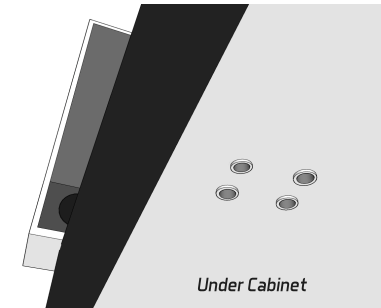

Hammer down the 4 T-Nuts under the cabinet

7 INSTALL THE SHAKER

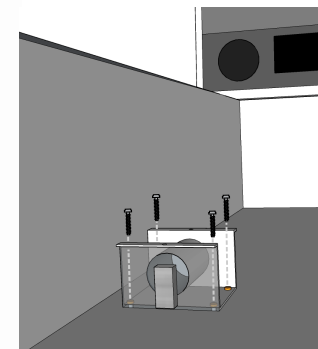

Place the shaker and secure it with the 4 screws

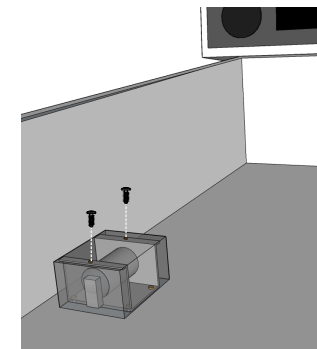

Place the shaker cover and secure it with the 2 screws

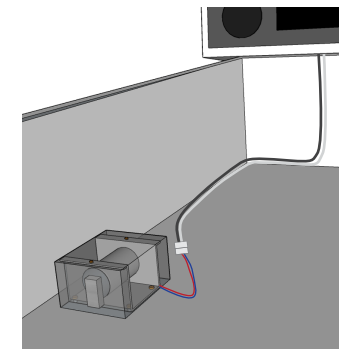

Connect shaker power wire

8 CHECK LED STATUS

Turn your machine ON and check the LEDs status

Full LED status information on www.pinsound.org/help

MotionControl

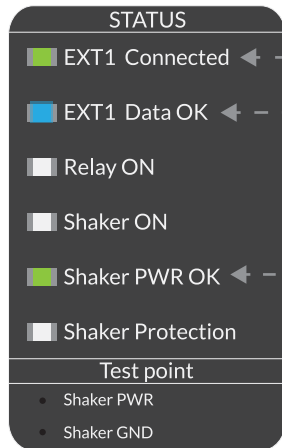

MasterEffect

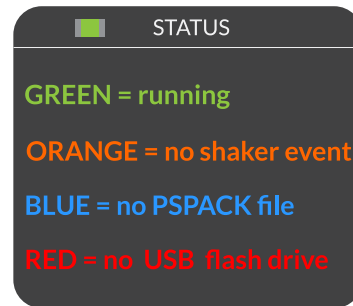

9 IF NEEDED: UPDATE THE MASTER EFFECT

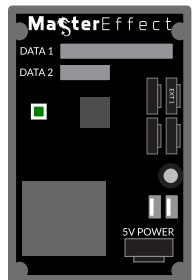

- Update the firmware of your Master Effect board

www.pinsound.org/help

- Download and copy the PSPACK Original file at the root of the flash drive

www.pinsound.org/machine

10 ENJOY!

Have fun with your new shaker!

NEED HELP?

Installation video
Firmware update
Guide
Q&A

www.pinsound.org/help



PinSound MotionControl MasterEffect



Standalone shaker kit for WPC 89 DCS

KIT CONTENT

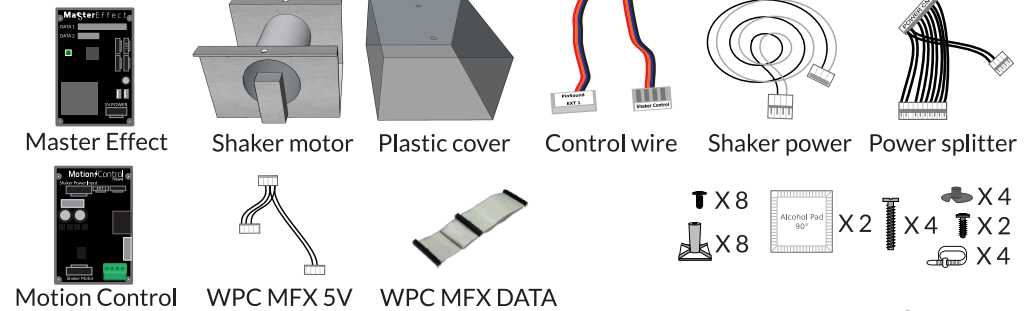

TOOLS



1 LOCATE THE CORRECT SPOT

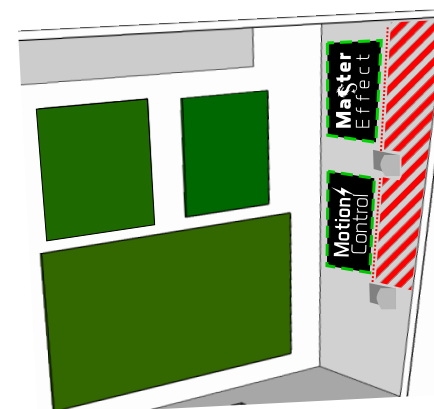

In order for the backbox to close, the 2 boards have to be placed behind the metal hooks

2 CLEAN THE AREA

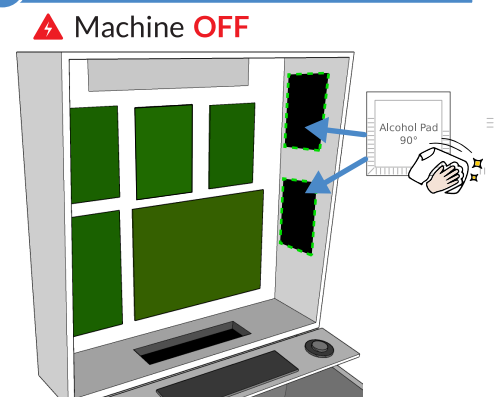

The Motion Control & Master Effect boards will be installed on the right inner side of the backbox